



M4A3E8

1/48
SCALE

山折り
Mountain fold
谷折り
Valley fold

切れ込み
Cut
切り抜く
Cut out

貼り合わせる
Paste together
のりしろ
Glue

1/5
PAGE

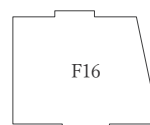
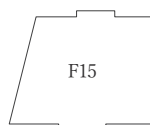
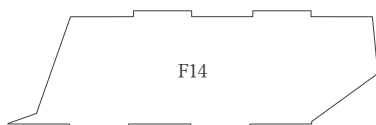
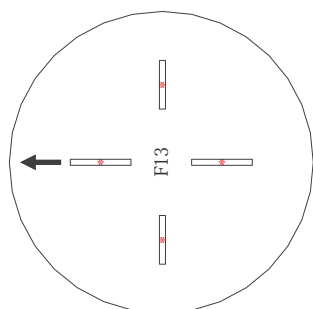
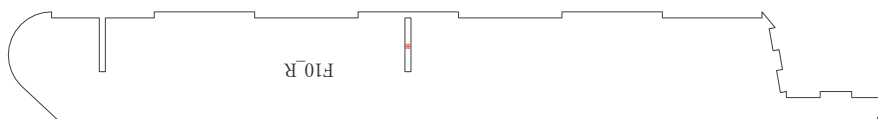
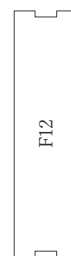
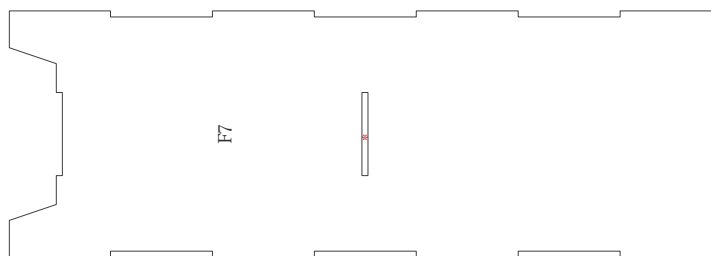
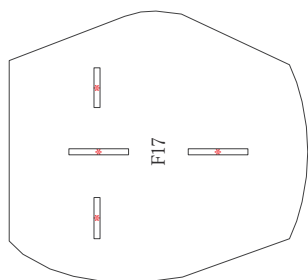
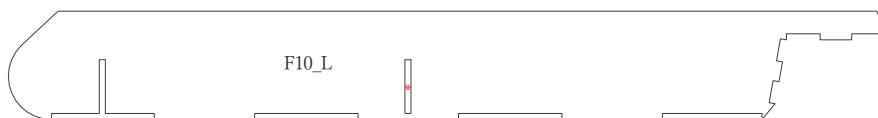
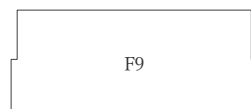
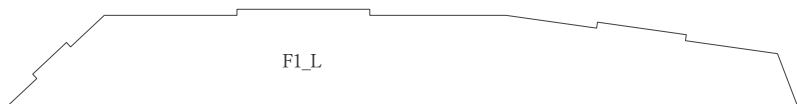
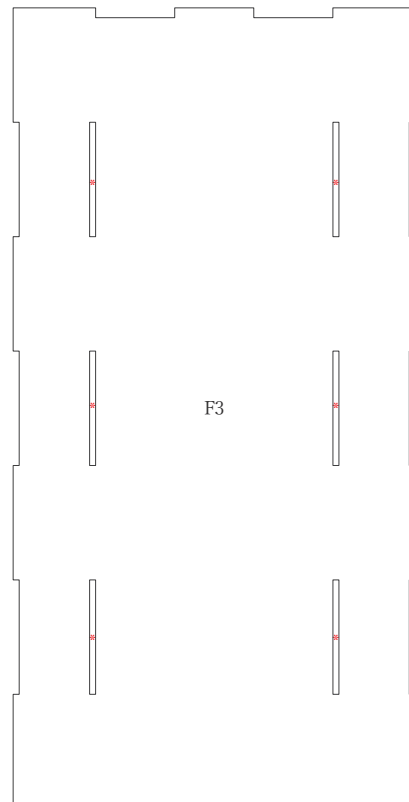
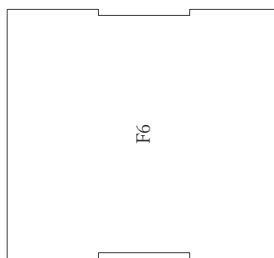
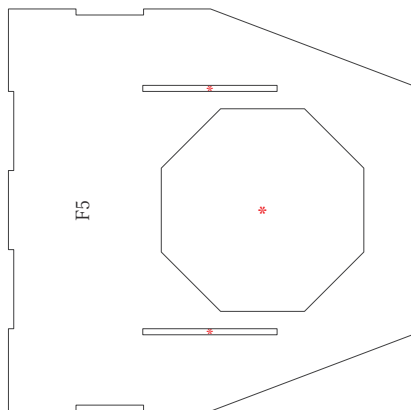
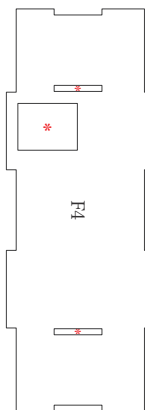



M4A3E8

1/48
SCALE

山折り Mountain fold
谷折り Valley fold

切れ込み Cut
切り抜く Cut out

貼り合わせる Paste together
のりしろ Glue

2/5
PAGE

This assembly sheet contains the following parts and instructions:

- Main Hull Parts:** A1 (top deck), A3 (side hull), A4.L/A4.R (side hull corners), A5 (hull front), A6.L/A6.R (hull front panels), A69 (hull rear).
- Engine and Interior:** A61, A62, A63.L/A63.R, A64.L/A64.R, A65, A66, A67, A68.
- External Details:** A7 (hull front), A8 (hull front), A9 (hull front), A10*/A10**/A10*** (hull front), A11 (hull front), A12/A13 (hull front), A14/A15 (hull front), A16.L/A16.R (hull front), A17 (hull front), A18 (hull front), A19/A20 (hull front), A21 (hull front), A22 (hull front), A23 (hull front), A24 (hull front), A25 (hull front), A26/A27 (hull front), A28 (hull front), A29 (hull front), A30 (hull front), A31/A32/A33 (hull front), A34 (hull front), A35.L/A35.R (hull front), A36 (hull front), A37 (hull front), A38 (hull front), A39/A40 (hull front), A41 (hull front), A42 (hull front), A43 (hull front), A44 (hull front), A45 (hull front), A46 (hull front), A47 (hull front), A48 (hull front), A49 (hull front), A50/A51 (hull front), A52 (hull front), A53.L/A53.R (hull front), A54 (hull front), A55 (hull front), A56.L/A56.R (hull front), A57 (hull front), A58 (hull front).
- Assembly Instructions:** Mountain fold (red dashed line), Valley fold (blue dashed line), Cut (yellow dashed line), Cut out (red asterisk), Paste together (yellow square), Glue (blue line).

箱之工房
BOX STUDIO
http://boxstudio.main.jp
M4A3E8



M4A3E8

1/48
SCALE

山折り Mountain fold
谷折り Valley fold

切れ込み Cut
切り抜く Cut out

貼り合わせる Paste together
のりしろ Glue

3/5
PAGE

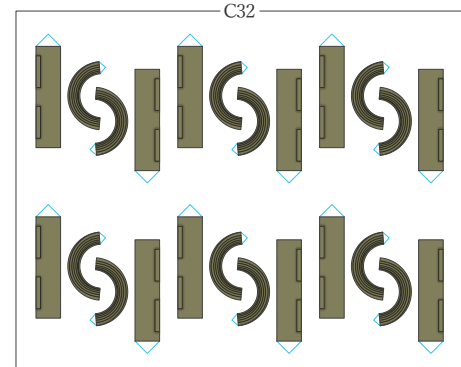
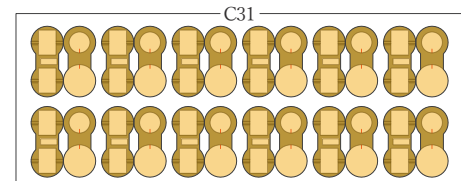
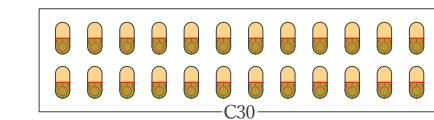
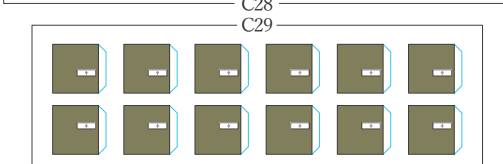
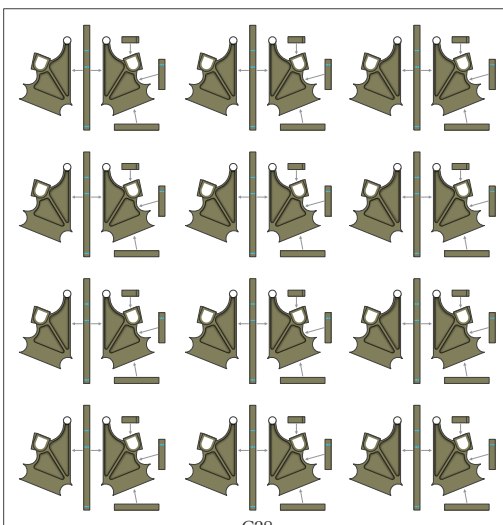
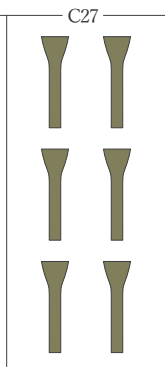
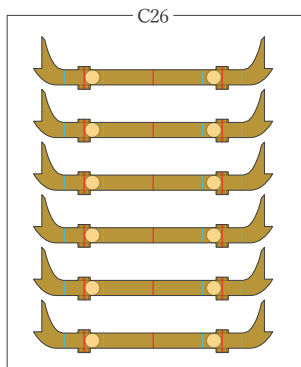
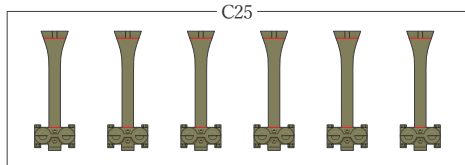
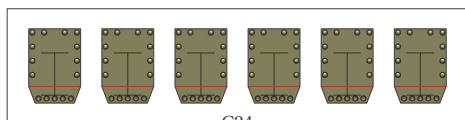
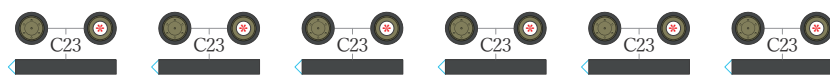
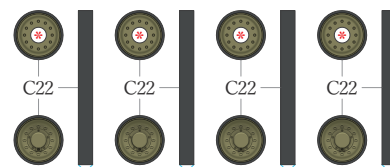
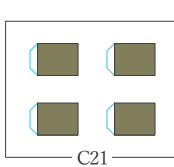
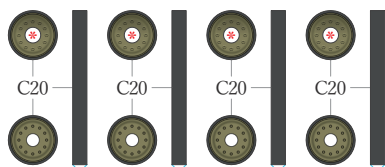
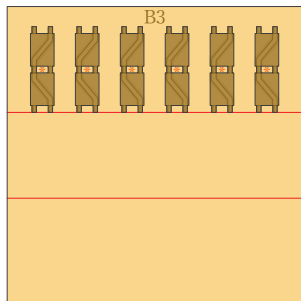
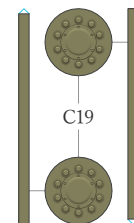
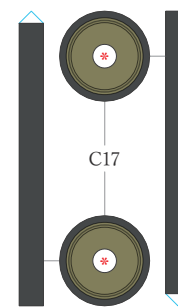
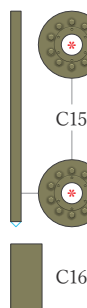
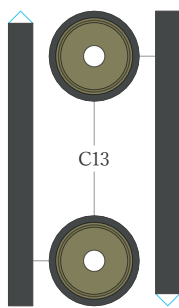
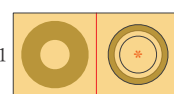
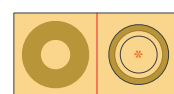
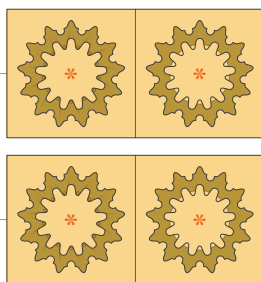
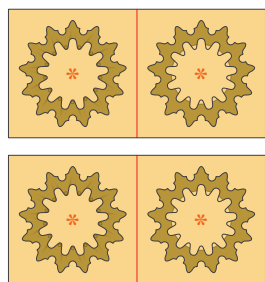
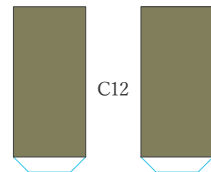
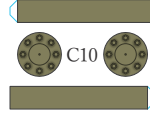
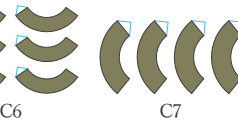
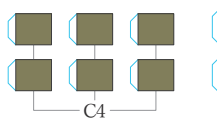
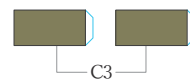
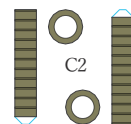
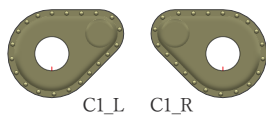
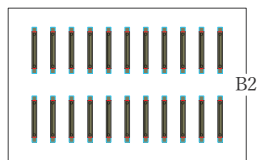
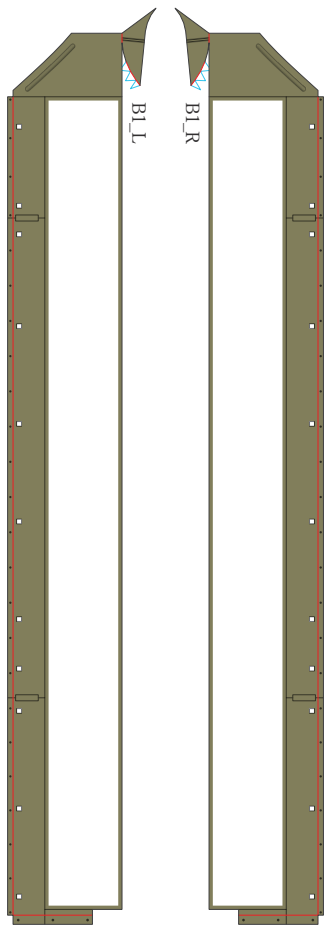



M4A3E8

1/48
SCALE

山折り Mountain fold
谷折り Valley fold

切れ込み Cut
切り抜く Cut out

貼り合わせる Paste together
のりしろ Glue

4/5
PAGE

C33

C34

C35

C36 C37

C38

C39

C40

C41

C42

C43

C44



M4A3E8

1/48
SCALE

山折り
Mountain fold

切れ込み
Cut

貼り合わせる
Paste together

5/5
PAGE

谷折り
Valley fold

* 切り抜く
Cut out

のりしろ
Glue

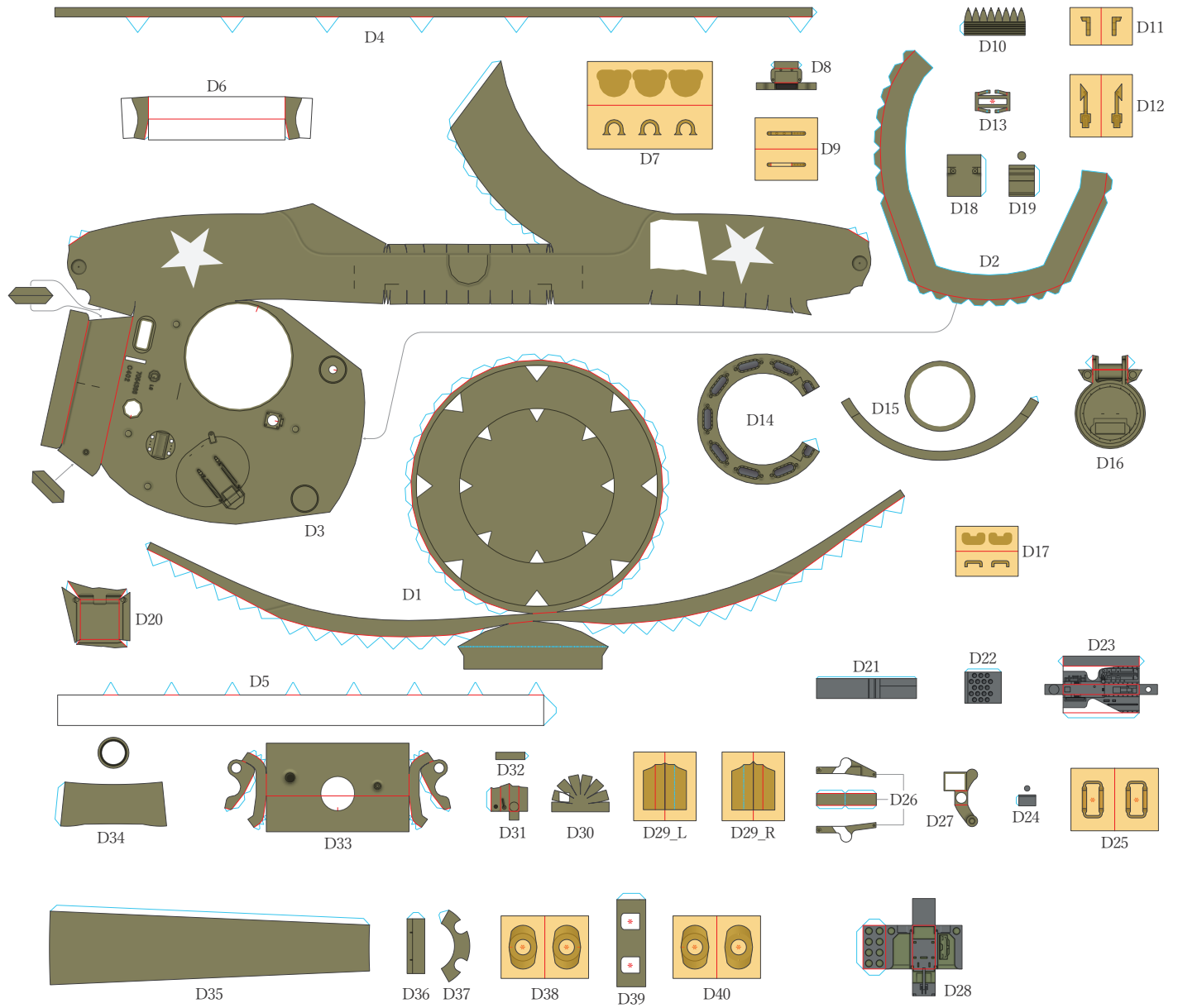

← Front

履帯はこの形に沿って作ってください。
Make the track in this shape.